

MAP ATTACHMENT IN RELATION TO RECOMMENDATION 258.1

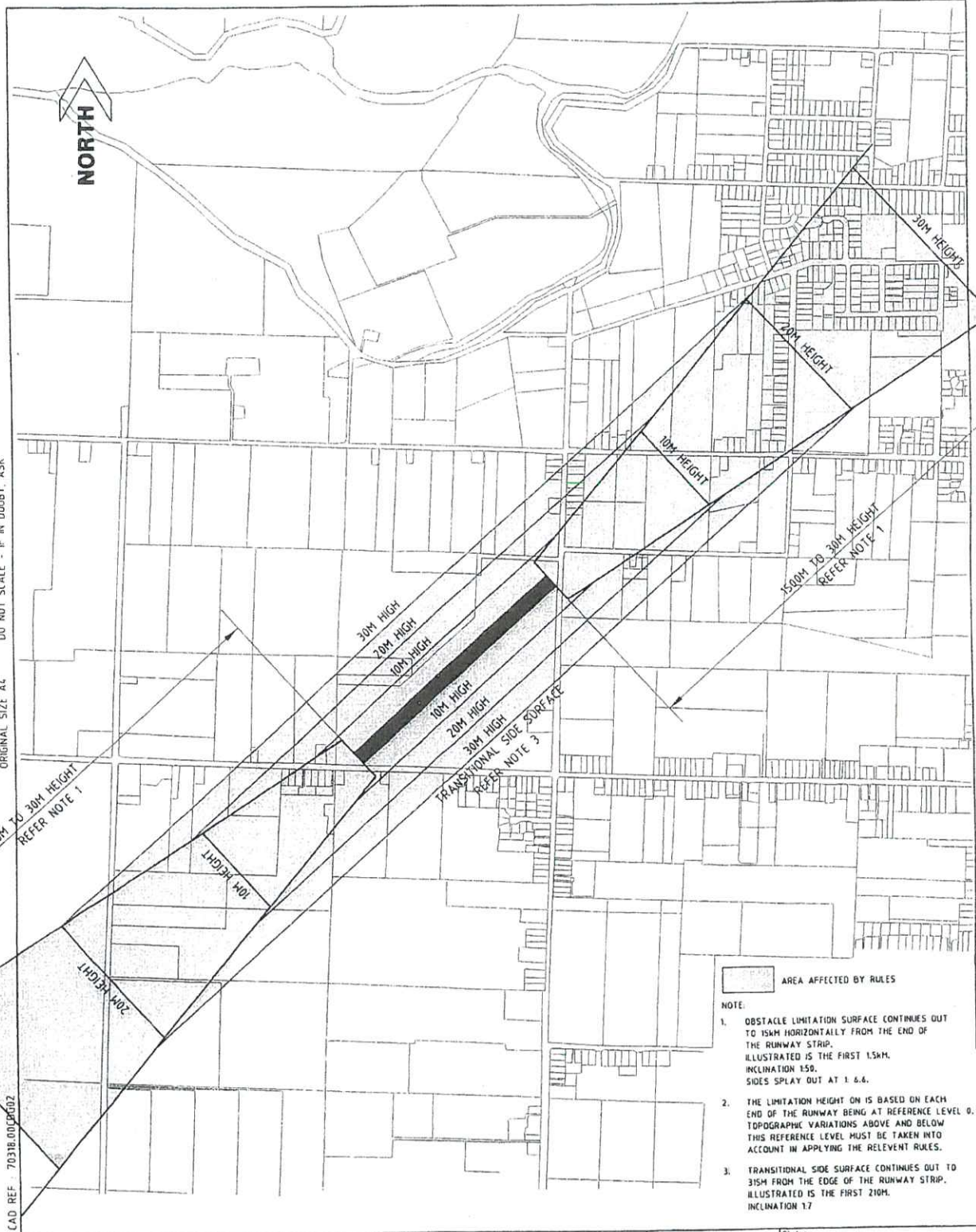

NOTE:

1. OBSTACLE LIMITATION SURFACE CONTINUES OUT TO 15KM HORIZONTALLY FROM THE END OF THE RUNWAY STRIP. ILLUSTRATED IS THE FIRST 15KM. INCLINATION 150. SIDES SPLAY OUT AT 1:6.6.
2. THE LIMITATION HEIGHT ON IS BASED ON EACH END OF THE RUNWAY BEING AT REFERENCE LEVEL 0. TOPOGRAPHIC VARIATIONS ABOVE AND BELOW THIS REFERENCE LEVEL MUST BE TAKEN INTO ACCOUNT IN APPLYING THE RELEVANT RULES.
3. TRANSITIONAL SIDE SURFACE CONTINUES OUT TO 315M FROM THE EDGE OF THE RUNWAY STRIP. ILLUSTRATED IS THE FIRST 210M. INCLINATION 1:7

SCALES: 1:15000

	INIT	DATE
DESIGNED		
DRAWN	J.P.	1/99
CHECKED		
APPROVED		

TASMAN DISTRICT COUNCIL
 MOTUEKA AERODROME
 SCHEDULE 16.11A AIRPORT HEIGHT CONTROLS



Status Stamp	Job No.	Sheet No.	Rev.
Date Stamp	70318.00	G02	A

Reduced copy - scale not true

Schedule 16.11A: Areas to which Height Control Provisions Apply – Motueka Airport



NOTES:

1. Obstacle limitation surface continues out to 15 km horizontally from the end of the runway strip. Illustrated is the first 1.5 km. Inclination 1:50. Sides splay out at 1:66
2. The limitation height on is based on each end of the runway being at reference level 0. Topographic variations above and below this reference level must be taken into account in applying the relevant rules.
3. Transitional side surface continues out to 315 metres from the edge of the runway strip. Illustrated is the first 210 metres. Inclination 1:7.

SCHEDULES

Schedule 16.11A: Areas to which Height Control Provisions Apply – Motueka Airport



Notes:

1. Obstacle limitation surface continues out to 15 km horizontally from the end of the runway strip. Illustrated is the first 1.5 km. Inclination 1:50. Sides splay out at 1:66
2. The limitation height on is based on each end of the runway being at reference level 0. Topographic variations above and below this reference level must be taken into account in applying the relevant rules.
3. Transitional side surface continues out to 315 metres from the edge of the runway strip. Illustrated is the first 210 metres. Inclination 1:7.

SCHEDULES

Schedule 16.11A: Areas to which Height Control Provisions Apply – Motueka Airport



Notes:

1. Obstacle limitation surface continues out to 15 km horizontally from the end of the runway strip. Illustrated is the first 1.5 km. Inclination 1:50. Sides splay out at 1:6.6.
2. The limitation height on is based on each end of the runway being at reference level 0. Topographic variations above and below this reference level must be taken into account in applying the relevant rules.
3. Transitional side surface continues out to 315 metres from the edge of the runway strip. Illustrated is the first 210 metres. Inclination 1:7.

Note 1 Sides Splay corrected 30/06/2004

SCHEDULES

Schedule 16.11A: Areas to which Height Control Provisions Apply – Motueka Airport

Original size A4 – Do not scale

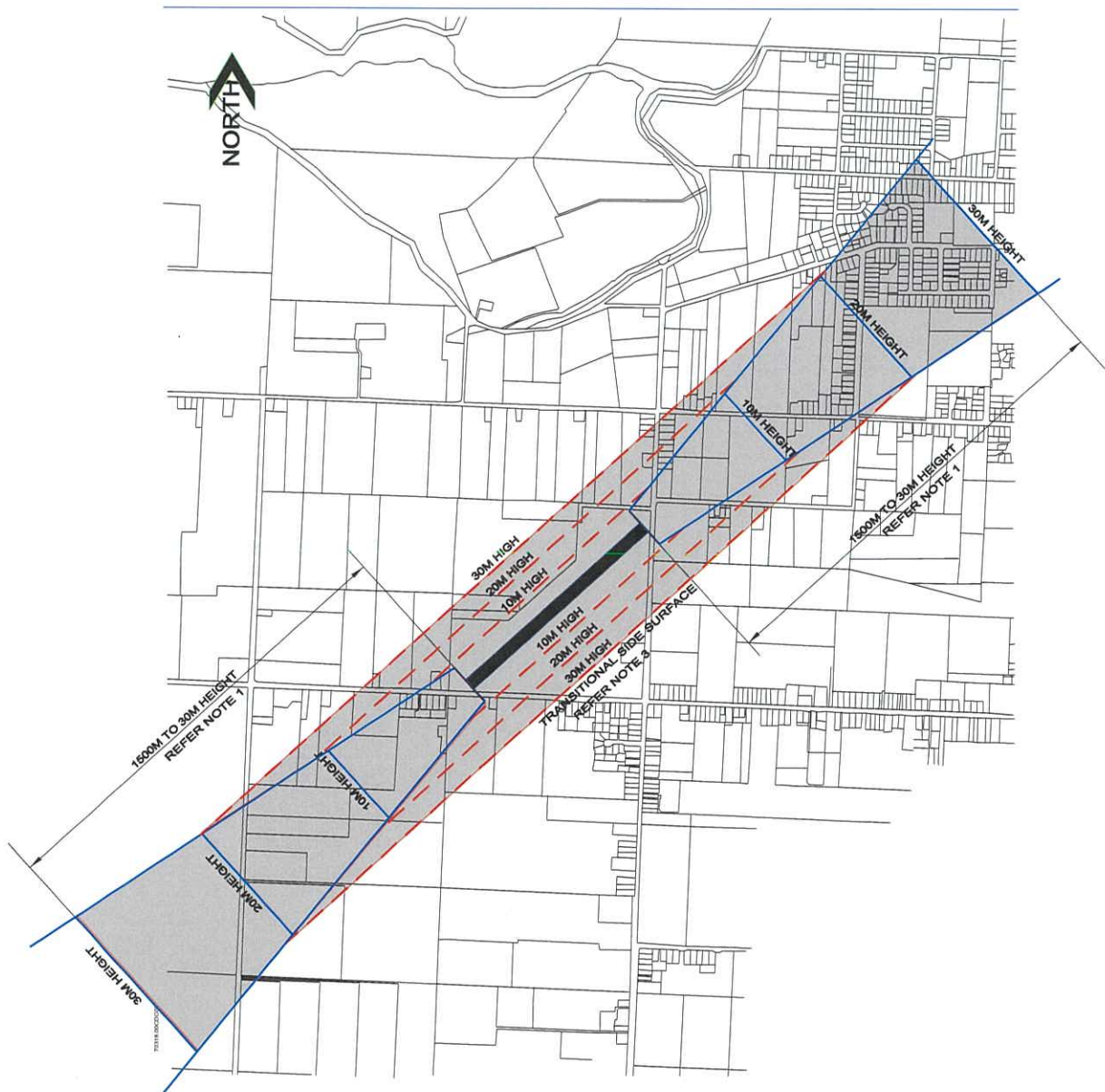

Notes:

1. Obstacle limitation surface continues out to 15 km horizontally from the end of the runway strip. Illustrated is the first 1.5 km. Inclination 1:50. Sides splay out at 1:6.6.
2. The limitation height on is based on each end of the runway being at reference level 0. Topographic variations above and below this reference level must be taken into account in applying the relevant rules.
3. Transitional side surface continues out to 315 metres from the edge of the runway strip. Illustrated is the first 210 metres. Inclination 1:7.